

Piping: Design Considerations TC-201

General Introduction to Piping Design in terms of:

- Rules and Regulations – PED or ASME set of rules.
- Determining of Operation and Design Parameters. How to set these from Process Specifications.
- Selecting of appropriate Piping Series with respect to
 - Pressure Rating
 - Assembly Method
 - Material
- Selection of appropriate Pipe Design Procedure – e.g.,
 - Steam Saturated
 - Steam Superheated
 - Clean Systems (Pharma)
 - Sewage
 - Heating/Cooling
 - Others
- Built in alternatives – for example shall Wafer mounted Valves have split or through bolting for later servicing?
- Determining of the need for Pipe Stress investigations.
- Design in 3D – how to utilize the 3D software.
- Detailing – insertion of Fitted Field Welds for example.
- Manufacturing Drawings – What information to put on the piping Isometrics?

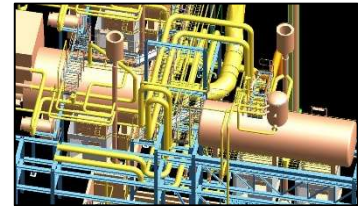

Pictures of different Piping Projects.

Trainees will get an introduction to above subjects.

Contact Information:

Christian Pallesen; +45 2526 8805; cp@p-engineering.dk