

Steam Boiler Plant: 60t/h SH R-311B

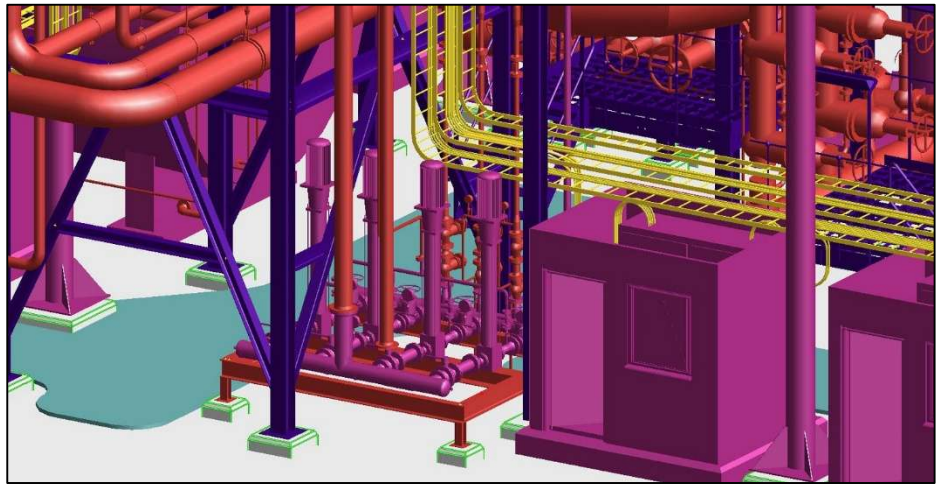

Pictures from a Steam Boiler Plant for a 16 barg Super-Heated Steam as an intermediate Steam Supply in the gap between demolition of a coal fired plant to construction of a Biomass Plant.

P-Engineering (PlantWare) designed all Ductwork, Pipework, Steelwork, Platforms and access ways, Special Blow-off Silencers, Kiosk for Water Treatment, Load Plans, etc.

Steam Boiler Plant 60t/h SH R-311B

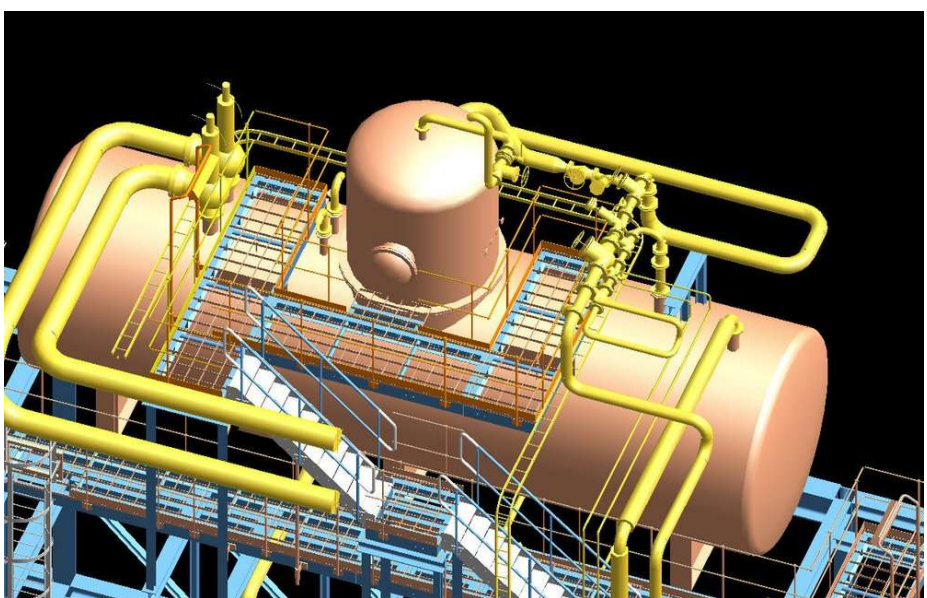
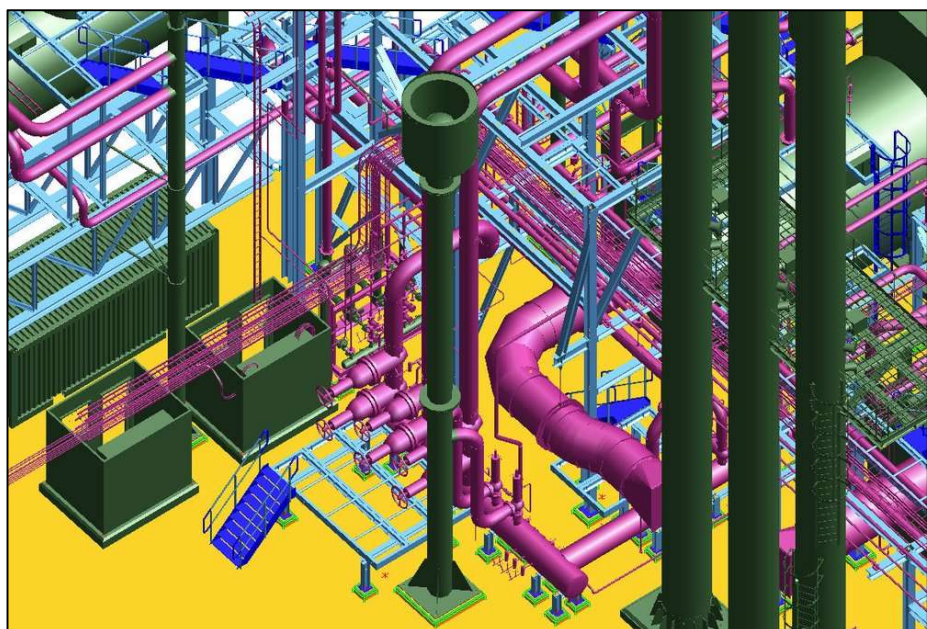
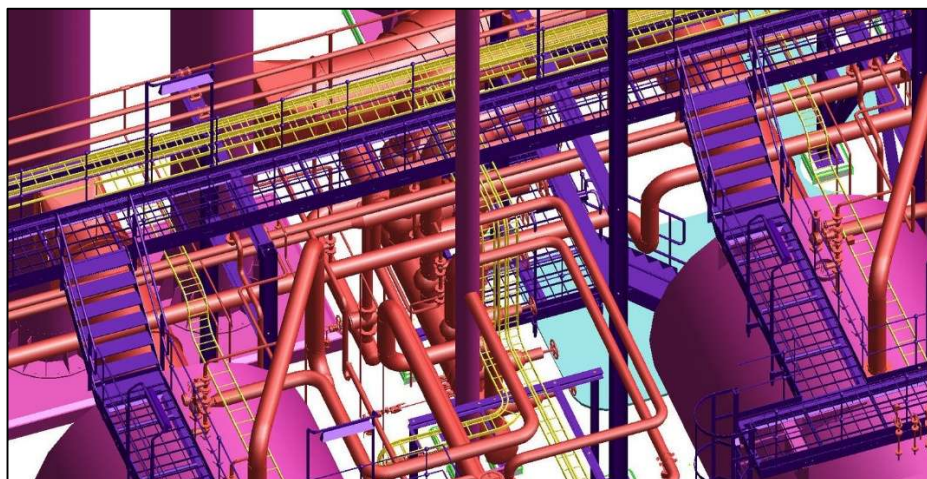

Steam Boiler Plant 60t/h SH R-311B

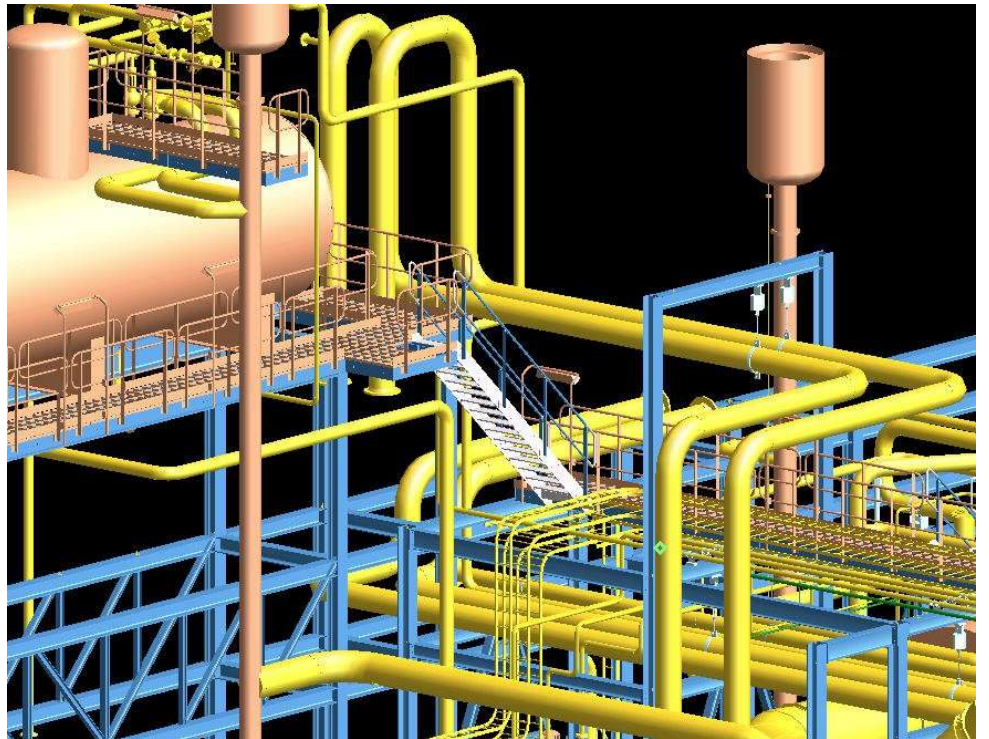
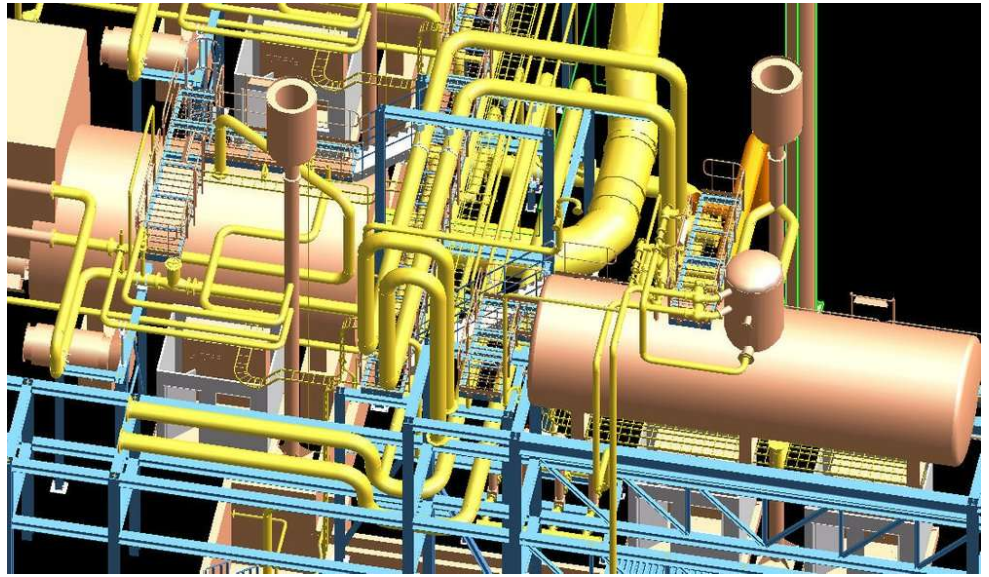

P-Engineering for example all engineering of Pipework for SH Steam, Condensate, Feed Water, Start-up Arrangements etc.: all piping with

- *EN13480 detail design of tube, fittings and flanges*
- *Rohr2 Pipe Flexibility Calculations*
- *CONVAL Safety Relief Valve Calculation*
- *FEM analysis of Special Standpipe for the Bespoken Safety Relief Silencer*

P-Engineering handled all Structural Steel as well including all access ways, gangways and platforms.