

Pharma Reference: Kill Plant

R-241

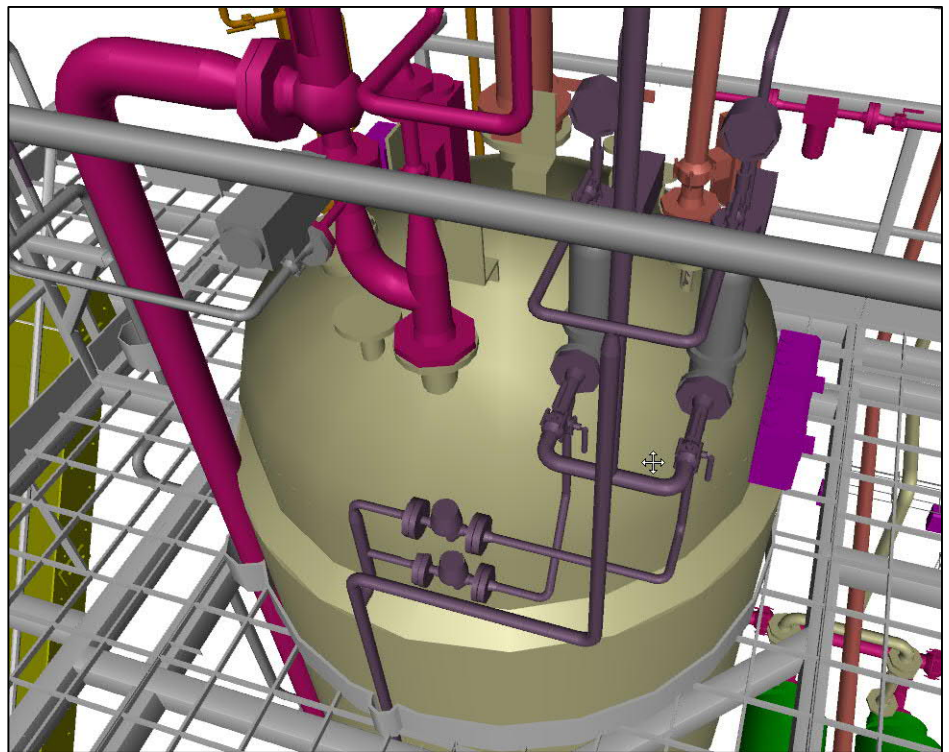
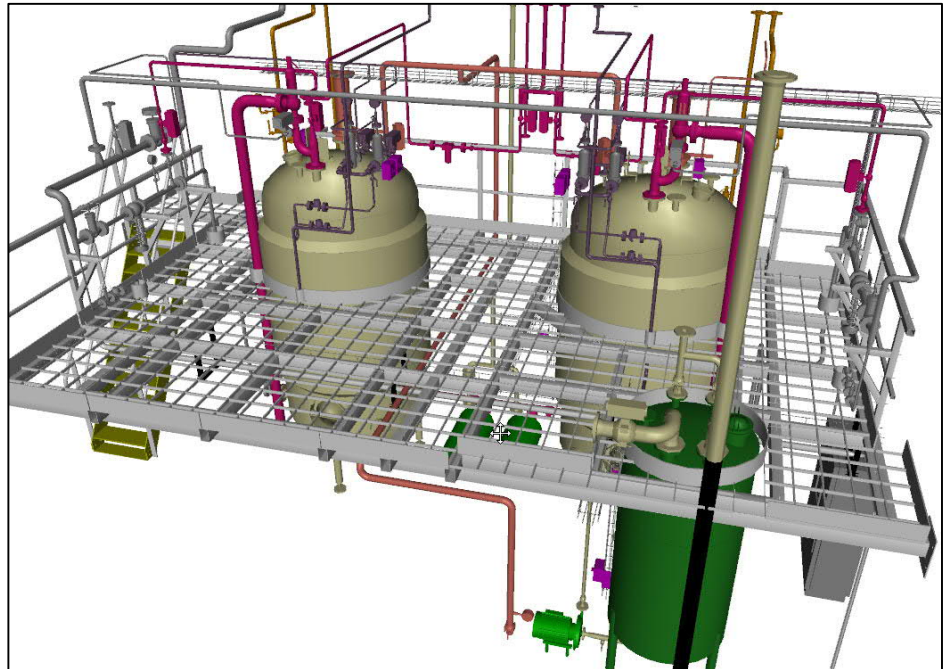

Pictures from a Kill Plant in a Pharmaceutical Factory in Denmark. Designed for 2 off Batch Kill Vessels. No heat recovery and cooled with cooling water based on Client Specification. Contract performed as EPCm.

P-Engineering made Special Design for e.g., Steam Injector Nozzles for optimum performance and low noise during operation.

Plantware

Pharma Reference: Kill Plant

R-241

