

Plantware

Utility Piping at Waste Incineration Plant

Project Details

Project	I/S RENO-NORD
Contractor	B&W Vølund A/S
Client	LH-Rørbyg A/S
Built	Aalborg, Denmark
Year	2004/2005

PlantWare A/S has designed pipe work for different utility systems at RENO-NORD, for LH-Rørbyg. 3D models already produced by B&W Vølund ApS formed the basis of the design.

PlantWare made the design based on 3D Plant Design tools from AVEVA Ltd: PDMS.

PlantWare designed

- » Piping installation for steam, water, condensate, blow off, oil and N-gas
- » Flue gas ducts arrangement
- » Tank support
- » Pipe supports
- » Catwalks

PlantWare delivered

- » GA - general arrangement drawing
- » DA - detail arrangement drawings of different systems, steel structures etc.
- » Load plans
- » Piping isometrics
- » Isometric pipe drawings
- » Steel detail drawings for pipe supports
- » Steel detail drawings for steel structure
- » PED
- » CE
- » MTO lists for piping components
- » MTO lists for steel elements

LH-Rørbyg has performed both production of piping and steel work as well as conducting the erection of steel and pipe work.

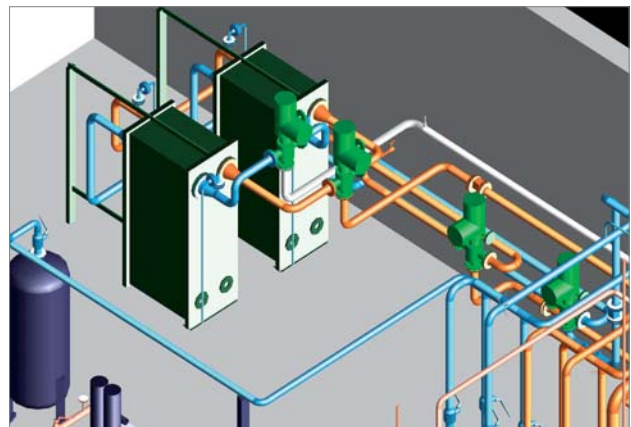
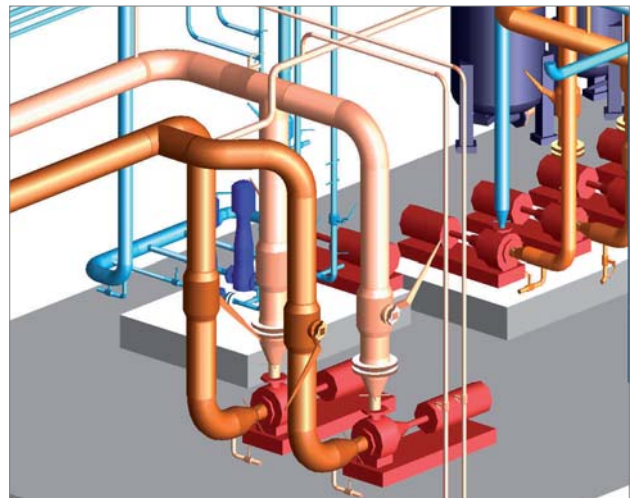

Contact



Christian Pallesen
Mobile +45 2526 8805
Email cp@p-engineering.dk