

## Commissioning: General

### P-951

Commissioning support for the Contractors with delivery of the following Services

- Design Review for pre-screening of Commissioning ability.
- Supervision during Pre-fabrication and Construction
- Start-up with initial Signal testing etc.
- FAT Test Specifications
- SAT Test Specifications
- Commissioning
- Performance Testing

P-Engineering can support our clients throughout the Commissioning process from Sub-supplier Supervision, General Start-up, Education of Operational Staff, to final Hand-over to Client.

FAT and SAT Test Specification will be generated and executed per functional Unit – e.g., Central Heating, AHU's etc. These will be based on Clients Functional Descriptions. P-Engineering can also help Generate the Functional Descriptions for both programming and testing.

Areas such as Sewage, Electrical, Heating, Cooling, Steam & Condensate, Ventilation, Water, Weather Stations, Sun Blinds, Lifts & Elevators, Indoor Climate etc. are covered.

#### Contact Information:

Christian Pallesen; +45 2526 8805; [cp@p-engineering.dk](mailto:cp@p-engineering.dk)

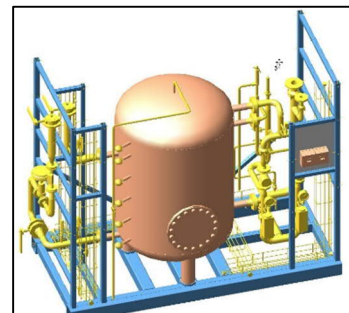
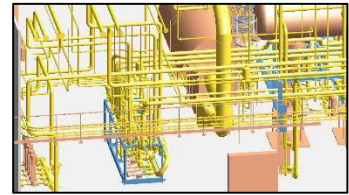

*Pictures from a various installation in Denmark, Turkey, and the United Kingdom of Steam & Heating, Condensate, Steam Generation and Hot Tap Water Production.*