

Structural Steel: Distillation

P-533

Structural Steel Solutions for Distillation Plants

- Piping Installations
- Platforms and Gratings and Access Ways
- Equipment Foundation/Support
- Cable Tray

Steel Tower are bespoke for the current application as Design Package, EPC or EPCm.

Steelwork is designed according to Eurocode and Platforms according to EN 14122 and be ball-proof Ø20.

P-Engineering delivers:

- General 3D Arrangement
- Detail Arrangement
- Structural Steel Design
- FEM-analysis of Structure including Wind Loads in relation to Natural Frequency of Structure
- Foundation Design handling Dead and Wind Loads
- Pipe Design and Isometrics for Water, Sewage, Heating, Cooling, Sprinkling, Drain etc.
- Pipe Support Design (Fix-points, Sliding Support etc.)
- Welding Specifications
- Surface Treatment Specification
- Erection Instructions

P-Engineering makes final Shop Drawings for Structural Steelwork and final BoQ for e.g., Bolts and nuts, Adhesive Anchors etc.

Contact Information:

Christian Pallesen; +45 2526 8805; cp@p-engineering.dk

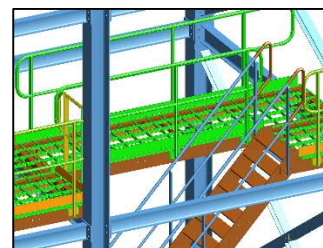
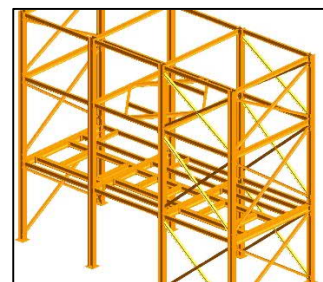
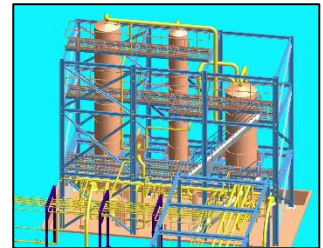

Distillation Tower from both 3D model and after finalized construction.