

Structural Steel: EUROCODE P-511

Steel Structures according to EURO-CODE for Machinery Installation, building etc. not requiring formal approval from Certified Engineer. Contract for either Design Package, EPC or EPCm.

P-Engineering designs special/be-spoken solution for Structures adapted to the Process Equipment, Piping, Access Ways and Electrical Equipment & Cable Trays for both Greenfield Project and revamp of existing plants, where P-Engineering handled all onsite measuring.

P-Engineering delivers:

- General 3D Arrangement
- Detail 3D and 2D Arrangement
- Structural Design with detailing of Bolting & Welding Connections
- FEM-analysis of Structure including Wind Loads in relation to Natural Frequency of Struc.
- Foundation Design handling Dead and Wind Loads
- Pipe Support Design (Fix-points, Sliding Support etc.)
- Equi-Potential Bonding
- Welding Specifications
- Surface Treatment Specification
- Erection Instructions

P-Engineering makes final Shop Drawings for Structural Steelwork and final BoQ for e.g., Bolts and nuts, Adhesive Anchors etc.

Contact Information:

Christian Pallesen; +45 2526 8805; cp@p-engineering.dk



Picture A) Structure for Cyclone B) Pipe and Platform Support C) Distillation Tower and Pipe Bridge and D) Pipe Bridge at Waste Incineration plant – [Vestforbrændingen](http://www.vestforbrændingen.dk) www.vestfor.dk

Structural Steel: EUROCODE

P-511

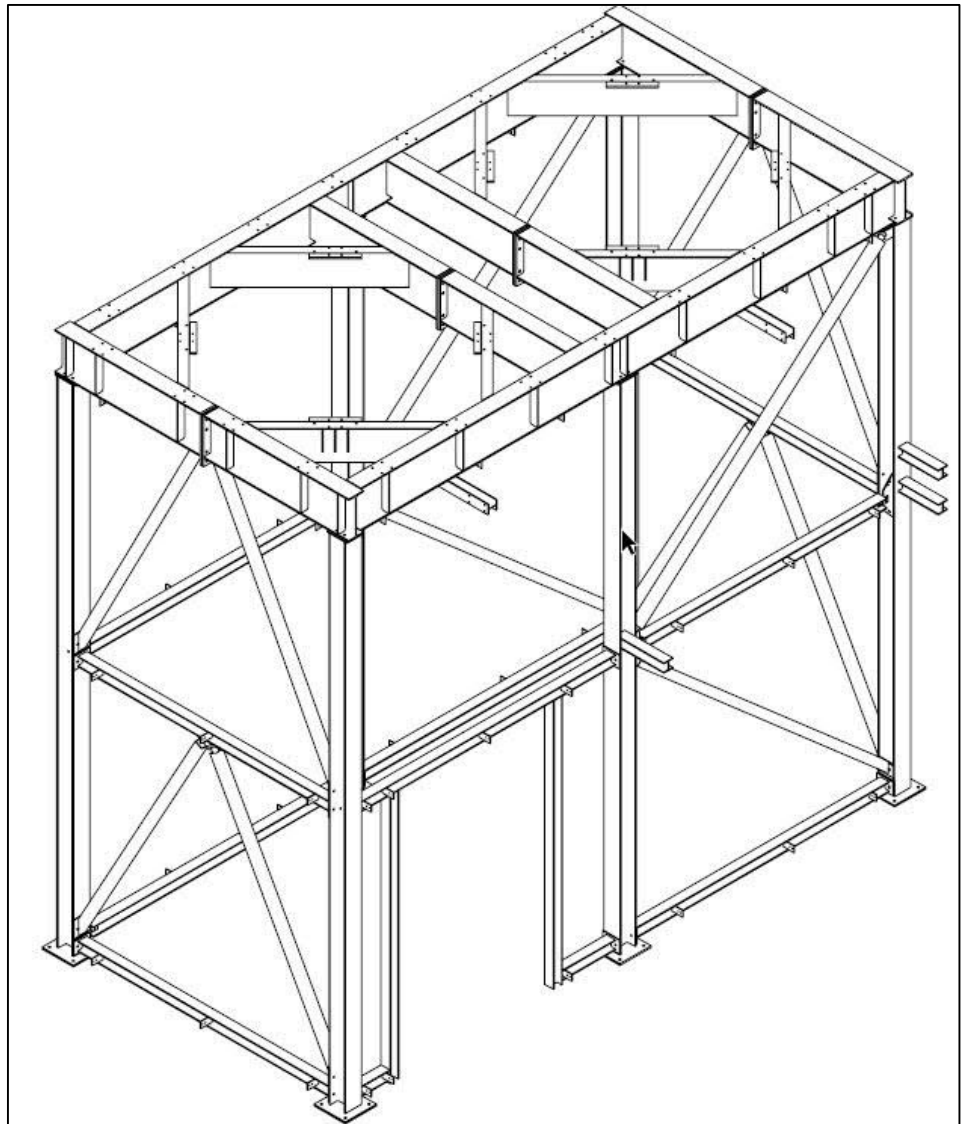

Top Picture shows a snap of a 3D Detail Drawing of a Steel Structure supporting 2 off Silos and Prepared for mounting Cover Plates for Machinery Room beneath. Below steel structure for a Roof House for Technical Installations with a cassette system for erection Solar Panels easily.