

Platform: Phar. Clean Design

P-502

Design of Platforms, Access Ways, Stairs and Ladders for Industrial purpose:

- Food & Beverage
- Pharma, Biotech and APIs

according to Eurocode and EN 14122 based on bespoke design with design loads of approx. 250 kg/m². P-Engineering designs with both straight and diamond orientation of Profiles. The latter for easier cleaning with no horizontal surfaces.

P-Engineering does 3D Layout of Platform System as well as Detailed 2D GA Drawings including Calculation of Structural Steel.

Shop Drawings are delivered for:

- Structural Steelwork
- Platform Frames
- Handrail Sections
- Stairs and Ladders
- Integrated Pipe Support Frameworks
- Mounting frames for e.g., Instruments, Fire Fighting Equip., Lighting Fixtures etc.

and final BoQ for e.g.

- Gratings Platform
- Gratings Stair Steps
- Bolts, Nuts & Washers
- Adhesive Anchors etc.
- Special Solutions

Contact Information:

Christian Pallesen; +45 2526 8805; cp@p-engineering.dk

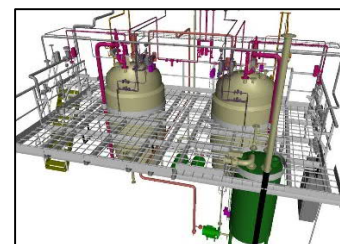
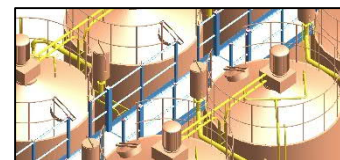
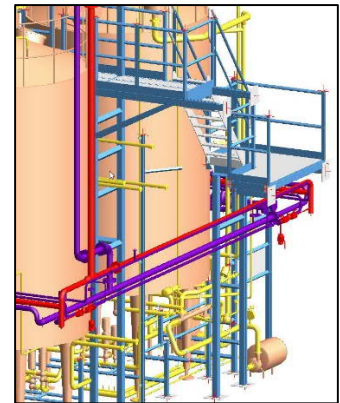

Top picture shows a pile of Platform frames ready for erection; Middle Pictures Platform at a Tank Farm and Bottom Picture shows Platform around a Kill Plant at a Pharmaceutical Plant.