

## Marine: LNG & Chem. Tankers

### P-481

Design according to 'Germanischer Lloyd' or other Classifications of

- Gas Tankers
- Chemical Tankers
- Combines Gas & Chemical Tankers

All installations coordinated with Hull Design

Gas:

- Pressure Tanks designed for Cryogenic Storage @ 6 barg @ -182°C
- Piping General
- Pump Installations
- Cross-over Manifold
- Cooling Installation with Compressor Installation
- SRV and Venting Arrangement

Chemicals:

- Pump Installations
- Piping Installations
- Cross-over Manifold

General:

- Access Way, Stairs etc.
- Electric Project and Cable Tray
- Kofferdam and Housing for Cooling Installation
- Support for Piping and Equipment

P-Engineering uses AVEVA PDMS, Conval®, Pipeflo®, and database applications for the overall Design. 3D model setup for CoG calculations.

Contact Information:

Christian Pallesen; +45 2526 8805; [cp@p-engineering.dk](mailto:cp@p-engineering.dk)

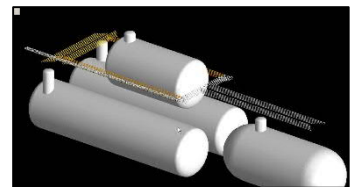
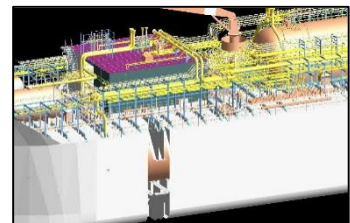
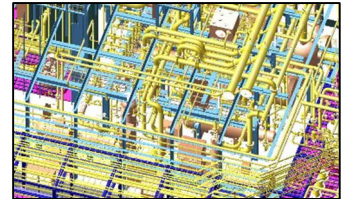

*Pictures from a Combined LNG Gas (4 tanks – reused from other ships) and Chemical Tanker (7 tanks) designed for Norwegian Skaugen (Defunct 2018)*