

Waste Inci.: Maintenance Filter P-419

P-Engineering designed a unit for providing Fresh Air in Boiler during Maintenance Work inside the Boiler upon request from Amager Waste Incineration Plant (www.a-r-c.dk). Design based on operation Furthermore, the unit removed dust from the Exhaust Air. Unit Equipped with

- ID Fan for Extraction
- Cyclone for removing larger particles
- Fabric Filter for removing smaller particles
- Instrumentation
- MCC and Power Distribution
- Remote I/O
- Pneumatic Buffer tank and Valve Cabinet
- Exhaust Silencer on Filter

Dust handling either through Plant General System of a big bag Station can be placed under filter and Clone.

The unit is prepared for Plant Central Control System but can also be delivered with a Standalone Control.

Unit were designed to be placed on top of roof on a Steel Frame. Prepared for lifting in as one lift.

P-Engineering uses e.g. [AVEVA PDMS](#) Software for 3D design and [SolidWorks](#) for Detail Design of Filter.

Contact Information:

Christian Pallesen; +45 2526 8805; cp@p-engineering.dk

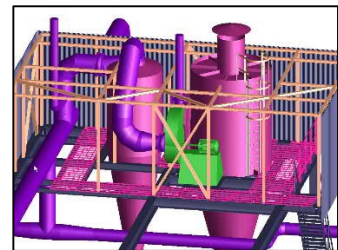
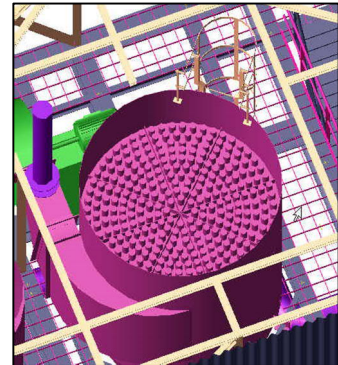
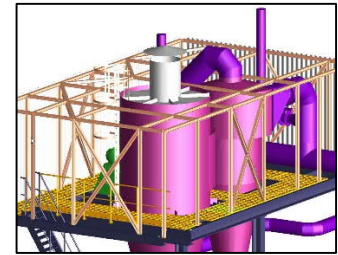

Design of Maintenance Unit for Fresh Air supply inside the boiler by Air Extraction. Exhaust Air will be filtered via Cyclone and Fabric Filter.

Hook-up to boiler hatches with intermediate Hose Connections.