

## Steam: Main Distribution P-315

P-Engineering designs Main Steam Distribution System for any Industrial applications. We design all parts of the Steam System such as:

- Main Steam with Safety Shut-off, Droplet trap & Monitoring for Outside Steam Supply
- Steam Header
- Start-up Arrangements
- Pressure Reducing Lines with Control Valves
- Steam re-evaporation from Condensate
- Condensate Collection
- Condensate Discharge with Pumps

Design package contains off:

- Pipe Arrangement; 3D
- Pipe Design; EN 13480
- SRV Arrangements
- Support Design
- Valve Sizing and Selection
- Vessel Design EN13445
- Pump Sizing
- MCC and Electrical Supply
- Instrumentation
- Process Control

For all areas manufacturing drawings will be created – Piping Isometrics, Support Details etc. P-Engineering will use [AVEVA PDMS](#) as 3D software and [DXT](#)-software for Pipe and Vessel Detail Calculation.

### Contact Information:

Christian Pallesen; +45 2526 8805; [cp@p-engineering.dk](mailto:cp@p-engineering.dk)

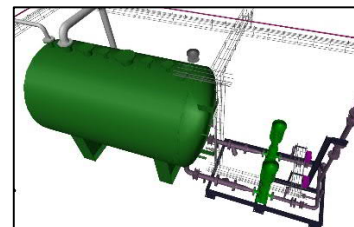
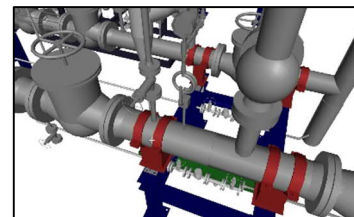
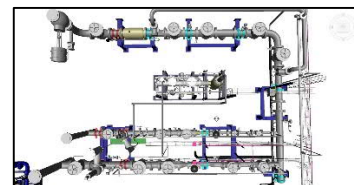
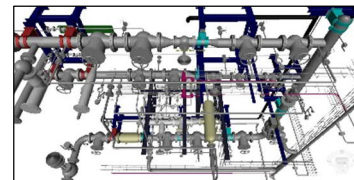
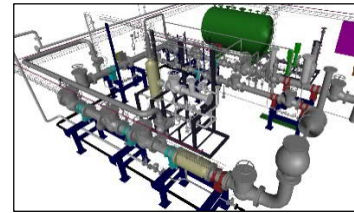

*Pictures from a Steam Utility installations in relation with a pharmaceutical plant (DK). Steam provided from off-site Boiler Plant*

## Steam: Main Distribution

### P-315



Pictures from Steam Manifold Supplied from 2 off [BWE Tøma](#) Steam Boilers 10 t/h @ 10 barg for a Pharmaceutical Plant (DK)