

Food & Beverage: Reception

P-294

Layout of Reception (Raw Milk),
Weighing in/out and Discharge
(Refined Products, Fats and Oils).

For Diaries and related Businesses. P-
Engineering engineering package
includes:

- PFD
- PID w. full TAG-numbering
- HMI Panels for Drivers registrator
and System Operation
- General Layout 3D
- Detail Layout 2D and 3D
- Pipe Layout and Detailed Design
- Support Struc. & Pipe Support

Design Package includes

- Piping Design acc. EN13480
- Steel acc. Eurocode
- Platforms acc. Eurocode
- Instrumentation
- Control System – General Spec.,
Functional Descriptions, SCADA
specification etc.
- Pumping Sizing and Selection
- Control Valve Sizing/Selection
- MCC's and Electrical Supply
- Cabling – Power, Signal & IT

P-Engineering uses e.g.

- [AVEVA PDMS](http://www.aveva.com) Software for 3D design – www.aveva.com
- [Pipeflo®](http://www.pipeflo.com) for Piping and Pump Sizing
- [CONVAL®](http://www.conval.com) for Control Valve and SRV Sizing
- [DXT](http://www.dxt.com) Software EN13445 and EN13480

Contact Information:

Christian Pallesen; +45 2526 8805; cp@p-engineering.dk

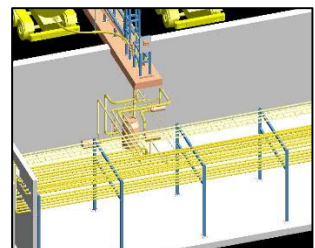
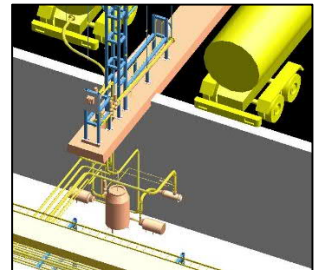
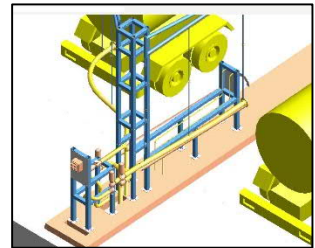
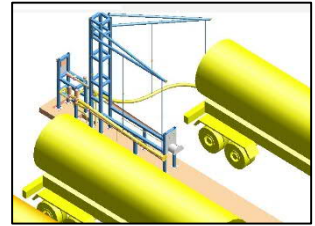

*Pictures from an Industrial
Cooling Installation for
Industry Designed for
Rambøll -*

www.ramboll.com

Plantware

Food & Beverage: Reception

P-294

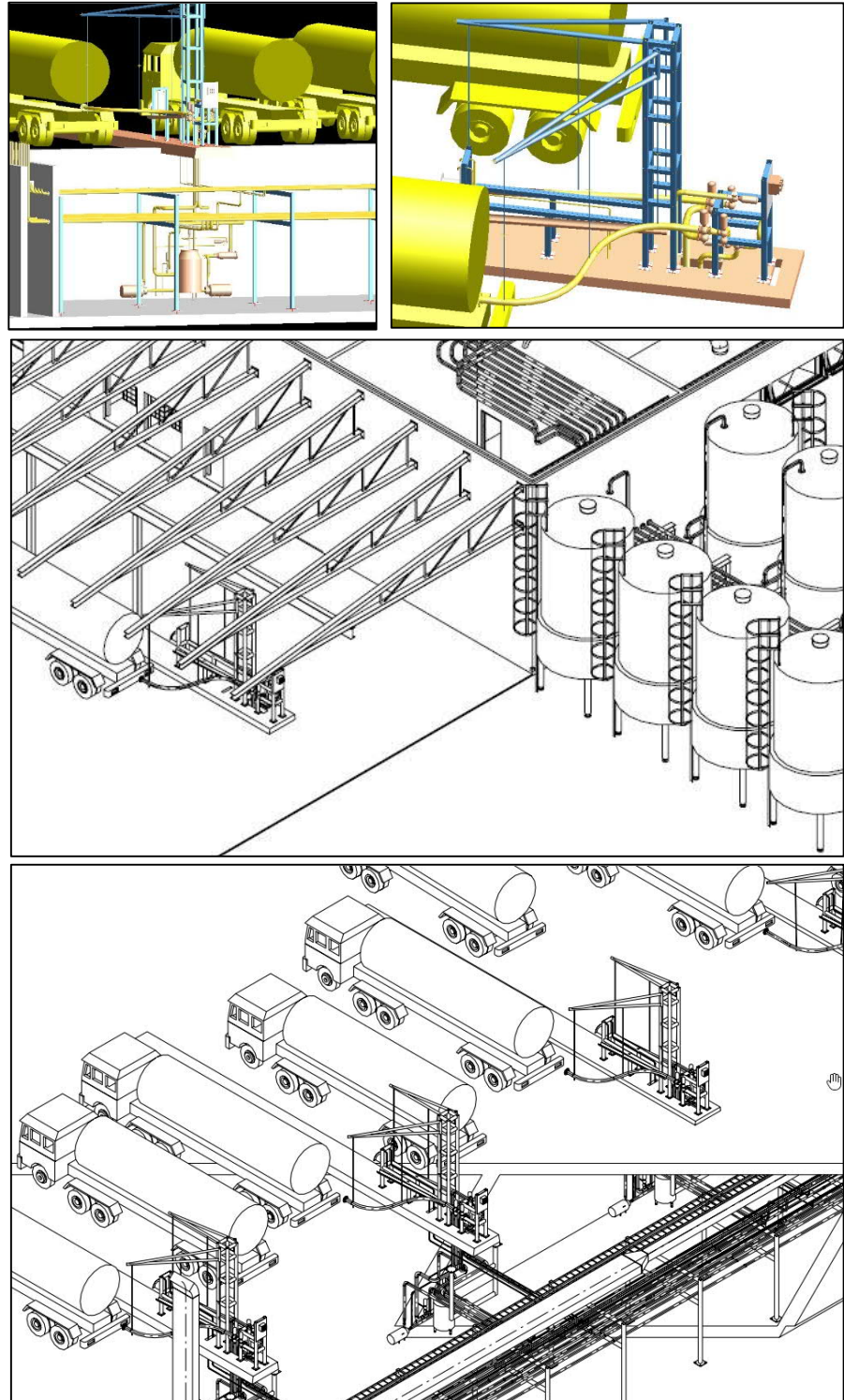

Project for Dairy in Texas (US) and Project (Project Investigation) for Gambogaard (DK).