

Pharma: Sugar Storage

P-212

P-Engineering performs design of Sugar Solvent Reception, Storage, and Supply to Production:

- PFD & PID
- Storage Vessel Design
- Platforms and Access Stairs and Ladders
- Support Steel and Pipe Bridge
- Mass Flow Metering
- Sample Station with Steam Supply
- CIP Cleaning Loop, Washing Machine Specially adapted for Sugar Storage.
- Piping – Process
- Piping – Utility
- Instrumentation
- MCC and Power Supply
- Remote I/O
- Functional Description
- Control System and SCADA Specification
- Measuring Setup and SCADA report for fully accountability toward Sugar Taxes.

Deliveries of Fabrication

Drawings:

- Piping – Process and Utility
- Steelwork
- Vessel
- Instrument Panels etc.

P-Engineering uses AVEVA PDMS for 3D, Solidworks for Vessel Design, DXT software for EN13480 design.

Contact Information:

Christian Pallesen; +45 2526 8805; cp@p-engineering.dk

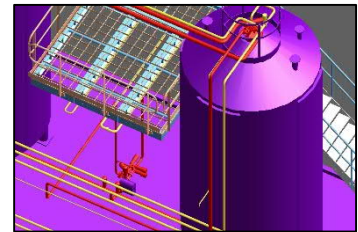
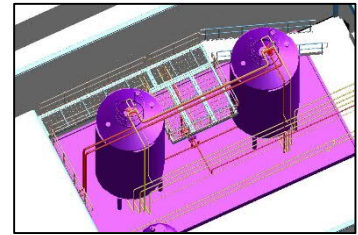

Pictures from a Sugar Storage receiving Sugar-solvent delivered in Tank Loaders. Reception designed with spool-piece to be mounted for Cleaning of Feeder Line. Picture from an API-factory producing Dextran.