

Central Heating: Flow Balance P-123

Design of Heating System with Flow/Hydraulic Balancing

- Traditional with Flow Restricting Valves (DK: Stregregulering)
- Industrial with Control Valves.

Traditional Systems are design with Flow Restricting Valves Sized for optimum hydraulic distribution throughout the piping system.

Industrial System are design with a Control Valves and Energy Metering for each section enabling the BMS system to even out the flows throughout the piping System.

Design:

P-Engineering designs with the following Scope:

- PID
- Process Calculations
- Valve Sizing
- Pipe Design
- Support Structure
- Pipe Support
- Instrumentation
- Insulation Specification
- MCC and Cabling Project
- BMS

P-Engineering uses e.g.

- [AVEVA PDMS](#) Software for 3D design
- [CONVAL®](#) for Control Valve Design
- [PIPE-FLO®](#) Pump Sizing and Pressure Loss
- [ROHR2](#) software for Pipe Flexibility Calculations

Contact Information:

Christian Pallesen; +45 2526 8805; cp@p-engineering.dk

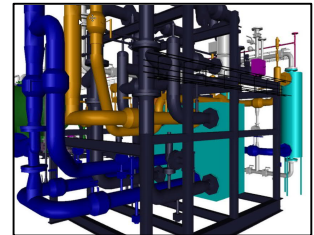
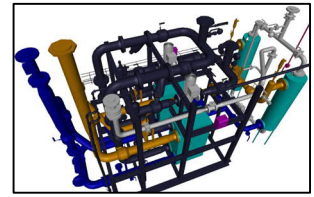

Pictures of 3D design of Unit and from and from a unit with final Insulation