

## Water Inst.: Hot Tap Water P-113

Design of Pre-fabricated Units for producing and distribution of Hot Tap Water.

### PED – Pressure Directive:

Design according to PED and detail design of Piping acc. EN13480 and Pressure Vessel acc. EN13445.

### Design:

P-Engineering designs District Heating and Heating Circulation System:

- PIDs
- Process Calculations
- Equipment Sizing (Pumps etc.)
- Pipe Design including of Pipe Isometric for fabrication
- Support Structure
- Pipe Support
- Instrumentation
- Insulation Specification
- Make-up Water System
- MCC and Cabling Project
- BMS – FD for PLC programming and SCADA input.
- Equi-Potential Bonding
- Bottom Exhaust (Man./Aut.)
- CE-marking with Tech. Dossier

P-Engineering uses e.g.

- [AVEVA PDMS](#) Software for 3D design
- [CONVAL®](#) for Control Valve Design
- [PIPE-FLO®](#) Pump Sizing and Pressure Loss
- [ROHR2](#) software for Pipe Flexibility Calculations

### Contact Information:

Christian Pallesen; +45 2526 8805; [cp@p-engineering.dk](mailto:cp@p-engineering.dk)

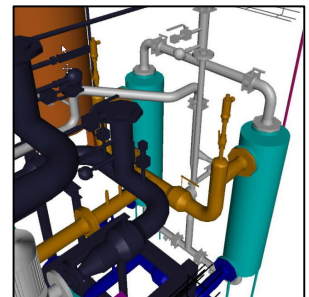
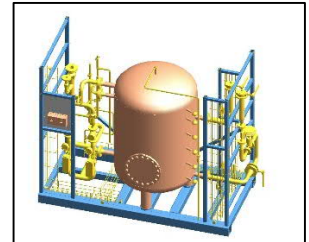

*Pictures of Hot Tap Water Units – above solution with Vessel and internal Coils and beneath a solution with Tube/Shell passing through Heat Exchanger*